

BAR

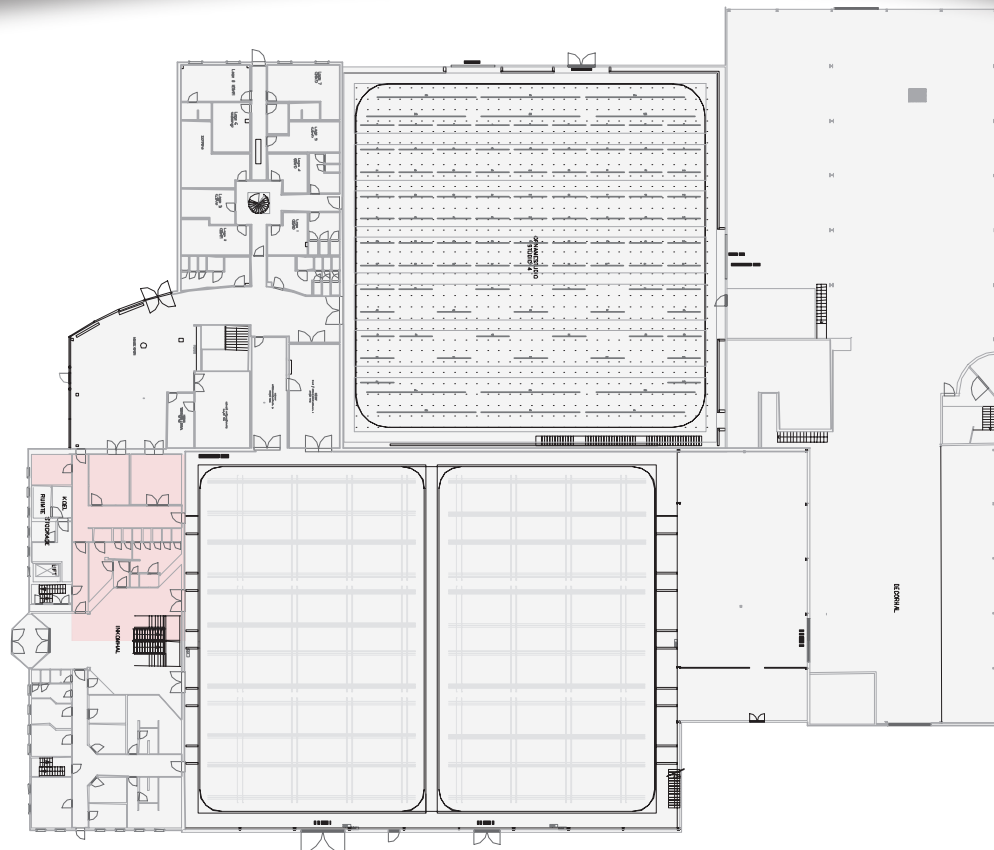

I. General information:

Name of complex: Studio 100 - Bar
2nd floor
Address: Nijverheidsstraat 17
Postcode: 1840
City: Londerzeel
Telephone: 03 877 60 35
Fax: 03 877 60 36
E-mail: Studio100@studio100.be

TECHNICAL DATA

2. Technical data:

2.1 Dimensions:

Cafeteria: 83 m²
- Length: 9,85 m
- Width: 8,42 m
Bar: 178 m²
(14,5 m x 8,42 m) + (8,34 m x 6,87 m)

2.2 Access doors:

- Acces via stairs (4,64 m)

2.3 Power supply:

- Various electrical sockets

2.4 Floor type:

- Vinyl

2.5 General facilities:

- Fully equipped kitchen
- Bar